

## Sconce "Spider" 7 still arms

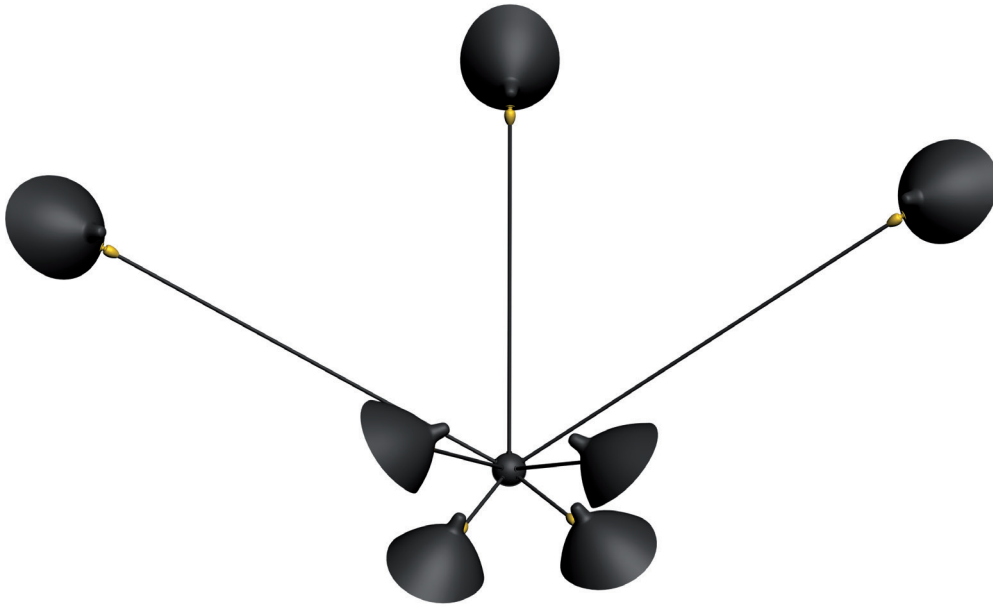

120V / 60 Hz  
7x60W incandescent

Suitable for indoor use only. Maximum ambient temperature 25°C.  
Caution : The luminaire shall be always connected to the main ground conductor.

Installation has to be carried out by a qualified electrician. This lamp must be permanently wired into the electric system. Always shut off power to the circuit before starting installation work.

The main conductors coming from the wall into the housing must have a minimal length of 15cm/6inch between the wall plate and the electrical connection to the lamp.

Smooth wire : connect to the line  
Ribbed wire : connect to the neutral  
Yellow/Green wire : connect to the ground

Different materials require different types of fittings. Always choose screws and plugs that are specially suited to the material.

If the external flexible cable or cord of this luminaire is damaged, it must be exclusively replaced by the manufacturer to avoid any hazard.

Shut off power to the circuit before changing the bulbs.

# Instructions

## Sconce «Spider» 7 still arms

1. Unpack without using any cutter or scissor because of possible scratches. Release the packaging of reflectors without removing it completely.



2. Screw the **2 set screws** into the thread to remove the plate of the half sphere. Remove it obliquely from the **fixed dog point**.

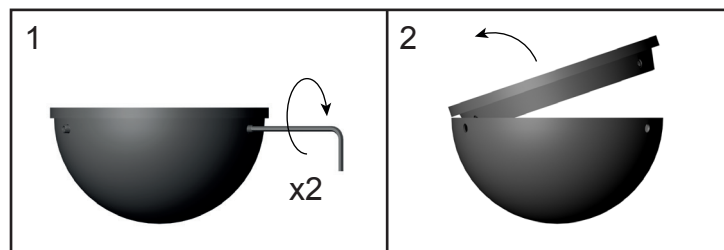

3. Unscrew the black cable (back side) to separate the plate from the lamp.

4. Screw the arms to the half-sphere. Screw the set screws in the half-sphere to avoid unscrewing.

5. Connect electrical wires by type (ribbed together, unribbed together).

6. Locate the positioning of the round plate to the wall. Only one position is possible (One fixed dog point and 2 screws of fixation).

7. Fix the round plate to the wall. Different materials require different types of fittings. Always choose screws and plugs that are specially suited to the material.

8. At this stage, at least 2 operators are necessary. Before starting, turn off power at main circuit panel. One operator maintains the lamp, second operator screws the black cable then connects electrical wires.

9. Place the lamp obliquely first on the fixed dog point. Then unscrew 2mm of the set screws.

10. Remove completely the packaging.